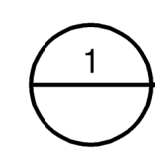
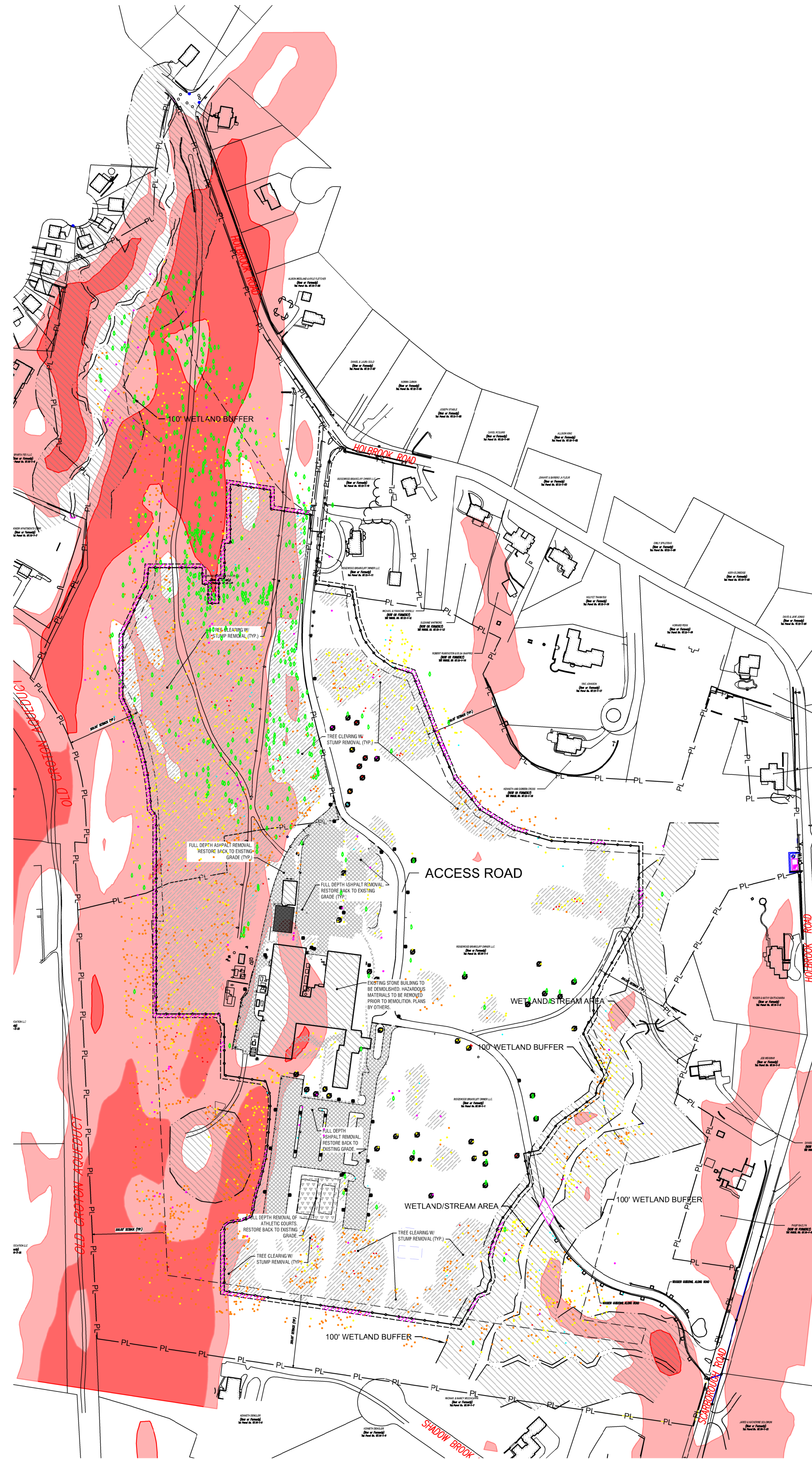

EXHIBIT J

Date & Time: 4/11/2023 6:56 AM By: James Taravella
Path: C:\Users\jtarav\YSG Dropbox\YSG Development Company\Portfolio\NY Westchester-Briarcliff Solar Engineering\DW Design Drawings\1 - YSG Generated Set\CD02 - Slope Mapping.dwg



1 PROPOSED TREE IMPACTS & SITE SLOPES

SCALE: 1" = 200'



TREE SURVEY LEGEND

TREE TYPE	SYMBOL	EXISTING	FULL TREE REMOVAL			TREE FELLING - NO STUMPING			TOTAL
			SLOPE <15%	SLOPE >15%	SUBTOTAL	SLOPE <15%	SLOPE >15%	SUBTOTAL	
NON-INVASIVE DEAD		138	53	36	89	1	3	4	93
NON-INVASIVE POOR CONDITION		67	19	18	37	0	3	3	40
NON-INVASIVE CRITICAL CONDITION		102	24	20	44	2	0	2	46
NON-INVASIVE FAIR CONDITION		1,288	263	414	677	18	26	44	721
NON-INVASIVE GOOD CONDITION		553	107	186	293	2	15	17	310
INVASIVE TREES		1,447	263	298	561	23	28	51	612
TOTAL		3,595	729	972	1,701	46	75	121	1,822

- TREE CLEARING
- TREE CLEARING - NO STUMPING
- ASPHALT DEMO
- BUILDING DEMO
- ATHLETIC COURT DEMO

- SLOPE RANGE
- 0 - 15%
 - 15 - 25 %
 - >25%

It is a violation of New York Education Law Article 145 Sec.7209, for any person, unless acting under the direction of a licensed architect, professional engineer, or land surveyor, to alter an item in any way. If an item bearing the seal of an architect, engineer, or land surveyor is altered; the altering architect, engineer, or land surveyor shall affix to the item their seal and notation "altered by" followed by their signature and date of such alteration, and a specific description of the alteration.

YSG SOLAR
79 MADISON AVE
NEW YORK, NY 10016

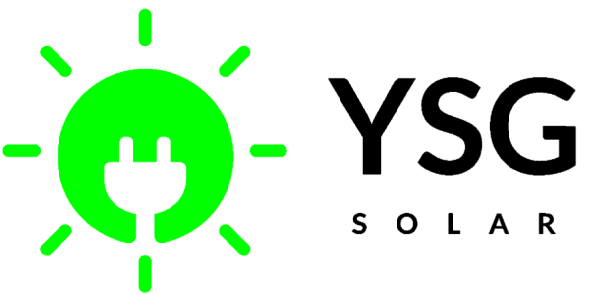

BRIARCLIFF SOLAR ARRAY
345 SCARBOROUGH RD
BRIARCLIFF MANOR, NY 10510

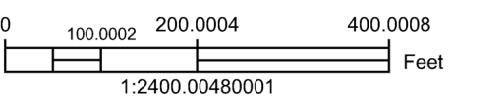

NO.	DATE:	DESCRIPTION:
REVISIONS		
PROJECT NUMBER:		

DRAWN BY:	JCT
REVIEWED BY:	JCT
ISSUED FOR:	REVIEW
DATE:	FEBRUARY 2023
DRAWING NAME:	

TREE IMPACTS

DRAWING NUMBER:

Figure 1